

May Newsletter 2022

Dear Parents and Carers

Firstly, I would like to congratulate our Year 6 and Year 2 pupils who completed their SATs. Everyone showed a growth mindset and tried their absolute best during the tests.

During the week beginning 6th June, all Year 1 pupils will be doing 'Phonics Screening' with myself and Mrs Cardy. Year 4 will also be starting their 'Multiplication' tests.

Over this school year, there have been many new initiatives for schools to follow such as the new EYFS Framework, The Reading Framework, Disadvantaged Strategy, Trauma Perceived Practice, Inclusion Framework, New Phonics scheme, attendance training; the list is endless. One new initiative is the lengthening of the school day. I will be sending you all information about this after the half term holiday.

It is hard to believe that we are now heading into our final half term of the year. I hope that you have an enjoyable half term holiday.

Regards

Mrs Bardetti

Headteacher

Second Hand Uniform

The PTA are going to be running a second hand uniform stall at the summer fete and they are also hoping to offer second hand uniforms to parents at school. After half term, please could you bring any unwanted uniform to the school and place it in the donation box at the school entrance. Thank you

Attendance

Our whole school attendance is now the lowest this school has ever encountered. This is now largely due to pupils taking holidays in term time. The government and the LA are putting a great deal of pressure on schools to improve their attendance figures. If your child is not able to attend school, please can you contact us with the reason. If we are not sure of the reason, we will still contact you to gain more information. If your child is absent and we are unable to contact you regarding the nature of the absence, this will be logged as an unauthorised absence which may incur a fine.

Jubilee Picnic

Everyone joined in a lovely whole school picnic for the Queen's Platinum Jubilee.



Golden Assembly

Date	Name	Date	Name	Date	Name
22.4.22	Bailey Gilchrist Freddie Bentley Matilda Griggs Maisie Harrop Elsie Glover Summer Rydon Mia Baines Leyla Mott Freya Cook Jack Westbrook Finley Gooding Jasmine Vaughan Chatfield Esme Emery Albert Smith Niam Patel Ricky Gallagher	29.4.22	Poppie Willis Tigan Finch Noah Spencer Sophia James Maisie Burnby Manni Luton Ellie Cates Eva Doherty Elsie -May Covey Madison Brown Emily Partridge Ella Herbert Imogen Watson-Charles Georgie Robins Oscar Galsworthy Alexis Will Nevaeh Leach George Burrell	6.5.22	Abiel Chase Arthur Shaw Isaac Quince Oliver Sturman Ollie Partridge Tommy Lynch Ayane Wares Matilda Grubb Ben Hamlet Elsie Hull James Paine Charlie Offord Chloe Eley Oscar Johnson Bradley Siddle Maggie-Mae Tulip
13.5.22	Tyler Craig All of UH Year 6's Jackson Lloyd Betsie-Mae Moore Libbie Brading Bella McKay Angel Vennell Thomas Hellard Yvette Anderson Olivia Izzard Kristen Harris Beaula Hoyle Jessica Siddle Scarlett Fahey Darcey Fox Issey Campbell	20.5.22	Josie Firkins Harvey Tilbury Katie Brand-Mustafa Anais Kalungwishi Alfie Smith Bella Birkett George Burgess Delilah Chandler All of LC Gabriel Myers All of LHW Abigail Shillito Jacob Hawkins Tayla Salsbury		

Kirby Tennis Festival

Well done and big congratulations to our Year 3, 4, 5 and 6 pupils who took part in a series of singles matches at Kirby Tennis Club.

Dulcie Tayler	Jack Hillier
Dylan Finch	Darcey Chandler
Bailey Gilchrist	Gracie Key
Lila Baines	Alex Taylor

Dulcie Tayler
Dylan Finch
Bailey Gilchrist
Lila Baines

Exciting Summer Plans - EYFS and Playground Markings

Over the summer, we will be using Sport Premium funding to remove our existing playground markings which are in poor condition and replace them with new designs! See below. This will improve active play; fun and fitness! In addition, the new markings will provide a resource for teachers to create outdoor maths, science and geography lessons.

EYFS – Physical development and ground markings



Hopscotch at the entrance is suggested, (also to activate children on the way in in the mornings!)

Retain the existing wheeled toy markings which as well used.

Numbered grid (to 25)

5x5 blank grid for versatile use

Double 10s frames

Targets on fences

Robust basket ball net.



1 2 3 4 5
6 7 8 9 10
11 12 13 14 15
16 17 18 19 20
21 22 23 24 25

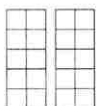
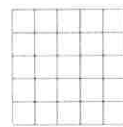

- Blank grid of 25
- Numbered grid of 25
- 2 tens squares
- Road markings
- 1-10 hopscotch
- Re do parking no. bays



LOtC in KS1 playground

The sketch diagram outlines the key points from this review. Key zones are identified along a design and continue from quieter more passive activities through to the faster more physical activities.

- NB Zones are located to keep clear of the main access routes around the space.

Existing coloured spots on the playground to be repainted. They are used to define the space and for lining up.

Ball skills zone identified on the field and defined using movable cones or barriers and robust goals.

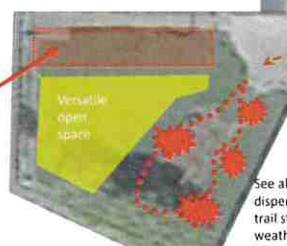

See also page 5. New dispersed challenge trail structures, with all weather link path.

KS2 new markings for learning and play.

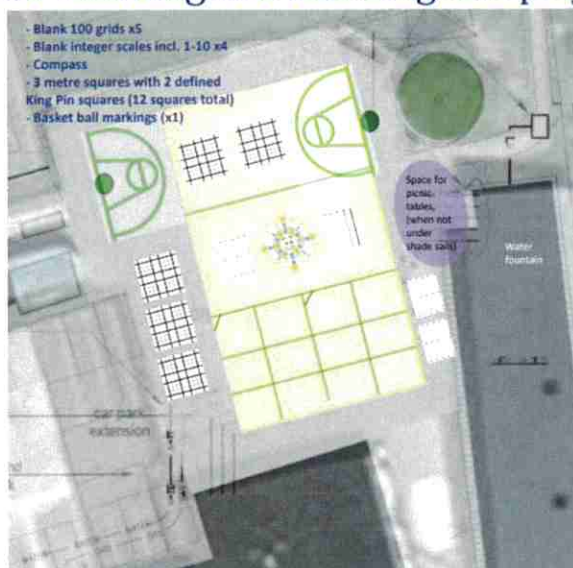

We will also be redesigning the learning zones in the EYFS outside area, adding a construction shed for loose parts play, a mud kitchen shed and a sand tool shed. The old blue sheds, and ramp, will be taken down to extend the bike area. New tarmac and roadmap markings will then be installed.

In order to use this area fully across all seasons, in line with our LOtC policy, all pupils will need wellie boots in school every day.

Cycling Courses

Congratulations to all of our pupils who completed a cycling course this term. Using our Sport Premium funding, we have offered Bikeability Level 1 (Year 4) and Level 1 and 2 (Year 6) for confident riders to learn to ride safely on the road and Learn to Ride sessions for KS2 pupils to develop their early riding skills. We will continue offering these sessions next year. Please see our website for more details.

<http://www.hollandhavenschool.co.uk/cycling-courses.html>

Governor Corner

Holland Haven's pupil attendance has always been very good and above average. Over the last 2 years covid has affected this greatly. As things return to normal it's important that your child attends school everyday. The DfE has released new attendance guidance and Mrs Bardetti, the school staff and Governors will be working hard to improve attendance levels for all children.

Katie Williams

Vice Chair of Governors

Dates for the Diary

27th May Jubilee Lunch

6th June - First day of the second half of the summer term

6th -10th June Phonics Screening

6th -10th June Year 4 Multiplication tables check

Essex Fire Museum has two special open days coming up:

- Tuesday 31st May (Jubilee open day – half term).
- Sunday 12th June (15 year anniversary)

On both days there will be opportunities for families to get involved in history trails around the museum, craft activities and a chance to sit on the fire engines (and squirt water 😊).

The museum is free entry (but visits are by appointment only.....as we are on the site of an operational fire station).

If families are interested, could they please email us at: museum@essex-fire.gov.uk and tell us the number in their party and the time they would like to arrive. This is just because we have to keep the station informed of numbers throughout the day.